



RHINO-TOUGH TRUCK BODIES

STEEL AND ALUMINUM TRUCK BEDS
AND SERVICE BODIES

THE COMPANY

In business for over thirty years comes decades of experience in upfitting vehicles and consistently surpassing customer expectations. Priding ourselves as a true one-stop shop operation for all of your vehicle and commercial needs, RhinoPro is the location to serve you. We are known for high quality parts, installation, honesty, integrity and unmatched customer service and are proud to be the place for all your automotive and upfitting needs.

To date, RhinoPro has acquired more than fifteen aftermarket stores from the West Coast all the way to Texas with no plans to stop our expansion. The company has plans to establish thirty-five to forty locations in the United States by the end of 2020.





ALUMINUM & STEEL SERVICE BODIES

RhinoPro Service Bodies are available in both rugged and reliable steel and aluminum constructions. With the largest selection of options and accessories, users can fully customize their service body for their own job application.

STANDARD FEATURES

- Available in Aluminum and Steel
- Body – Powder Coated White Finish
- Gas Spring Shock Door Holders
- Compression Whale Tail Handle
- LED Lighting in All Compartments
- Flip-top Compartments
- Automotive Weatherstrip
- Double Panel Doors with Internal Reinforcement
- Rear Camera Integration
- Step bumper with aluminum tread plate
- Wheel Body Trim
- Adjustable Shelves and Dividers
- Adjustable Tie-down Points
- Plug & Play Wiring Harness
- Programmable Strobes Built into Tail Lights
- State of the Art, Industry-Leading Material Rack
- Masterlock Ready

- 100% Primer & Topcoat
- Super Durable Powdercoat Provides Coating for Years of Protection
- Zinc-rich Primer
- Individually Coated Components for Maximum Coverage

Rhino Shield Warranty

- Steel 4-year 50,000 Miles
- Aluminum 10-years Against Rust & Corrosion



TOGGLE SWITCHES:

The toggle switches make lighting up your RPT service body a one touch solution.



FLIP TOP COMPARTMENT:

The Rhino Pro Truck (RPT) flip tops allow for easy access with the adjustable dividers, slam latched and LED lit compartments.



GAS STRUTS:

The RPT service body is equipped with gas struts on the vertical and flip top doors to ensure the longevity and functionality of the compartment door.



INDICATOR LIGHT:

The green indicator light is designed to notify the driver when the LED compartments and led lights are in use.



ADJUSTABLE SHELVING:

The RPT body features adjustable shelving in all vertical compartments.





MATERIAL RACK:

Industry-leading material rack is always ready for the toughest job site.



The RPT also comes with a unique accented fender flare.



RPT shown with standard LED lit compartment.



BED-LIT LEDS:

The RPT features a LED lit bed powered by a toggle switch (standard feature).



GAS CAP:

The RPT features an industry first sleek concealment of the fuel cap.



BUILT-IN STROBES:

The RPT enables the rear taillights to function as multi-patterned strobes .



ENHANCED LOCK MECHANISM:

The RPT features a tri-lock mechanism to ensure the security of your essentials.

SERVICE BODY CONFIGURATIONS

DON'T ADJUST TO YOUR BODY. MAKE YOUR BODY ADJUST TO YOU.

With an array of sizes and configurations to choose from, there's a Rhino-Tough Service Body designed to meet the specific needs of your industry and your fleet.

Chassis Style	C.A.	A	B	C
RPTA9878 SW	56"	78"	49"	14.5"
RPTA9878 DW	56"	94"	49"	22.5"
RPTG11094 SW	60"	78"	49"	14.5"
RPTG11094 DW	60"	94"	49"	22.5"
RPTG13494 DW	84"	94"	49"	22.5"

SW - Single Wheel | DW - Dual Wheel

Cargo area wheel well boxes may be necessary to accommodate some chassis.

RPTG11094, RPTA9878, RPTG13494: Rear View

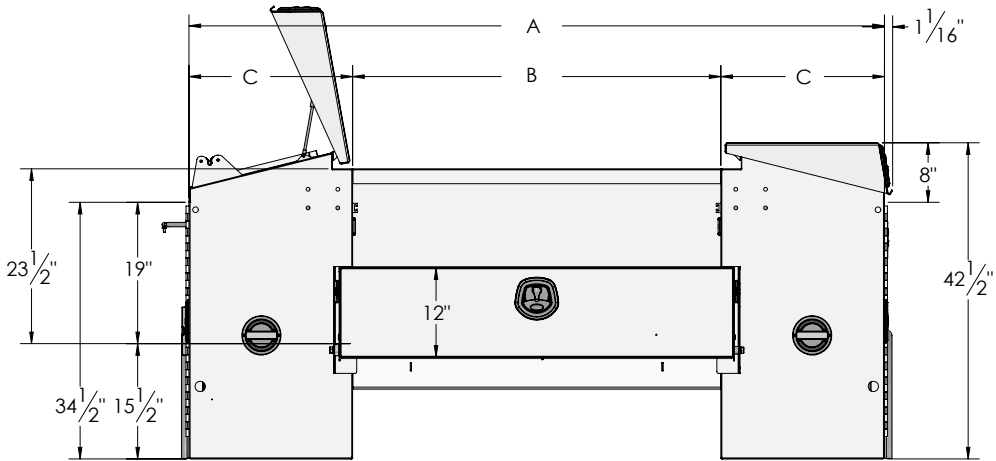

RPTA9878: Side View

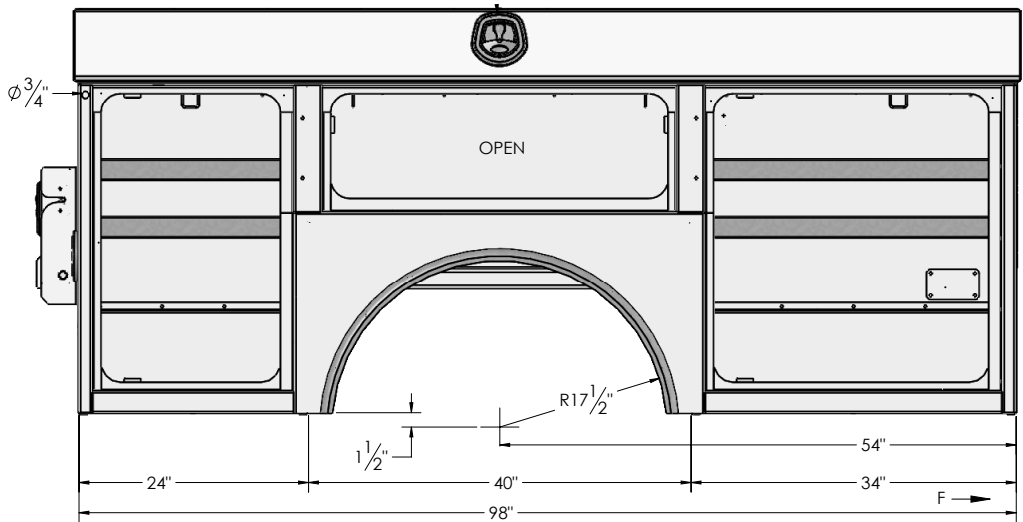

RPTG11094: Side View

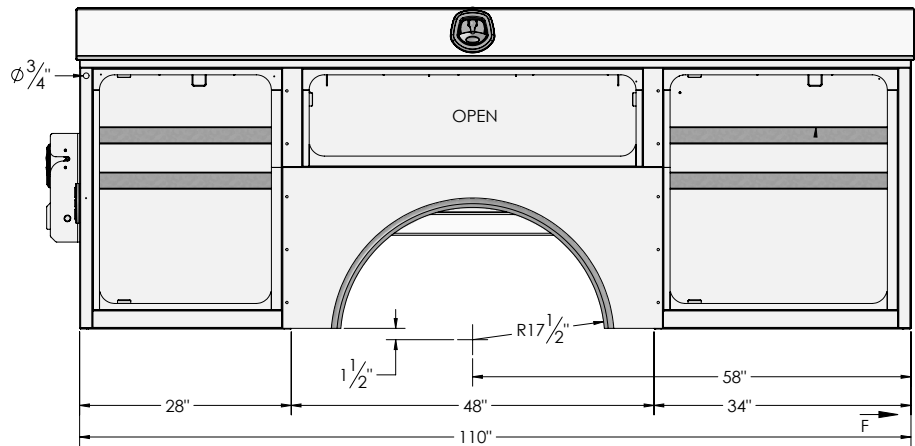

RPTG13494: Side View

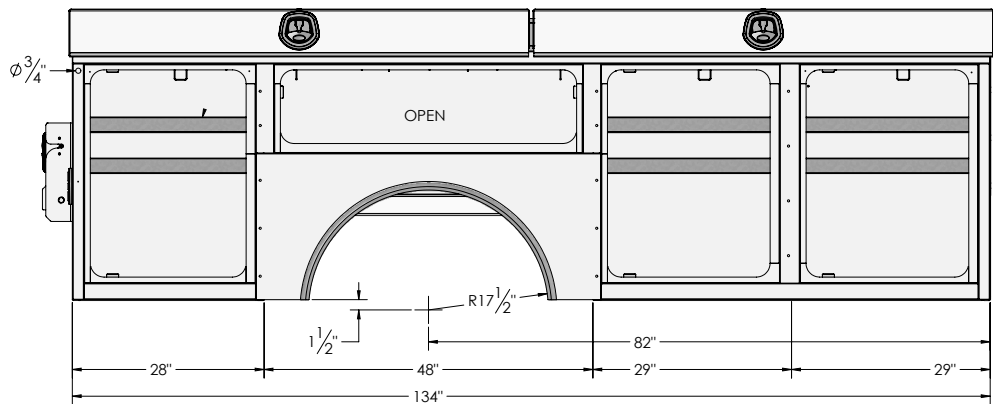

BUMPER

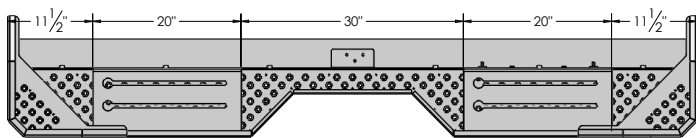

RACK

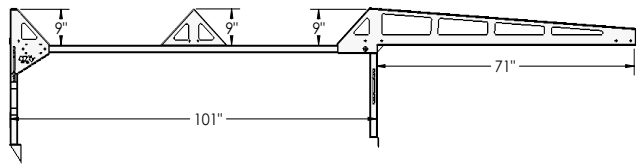



WWW.RHINOPROUS.COM

f RHINOPRO @ RHINOPRO_US ✱ RHINO PRO



© 2020 RhinoPro Truck Outfitters